

ISSUE HIGHLIGHTS:

- Building Better Schools 2020
- Reconciliation Week
- CFI I's Bear Hunt
- Year 9 Stagecraft



DIARY DATES

PLEASE VISIT THE PARENT
CALENDAR VIA THE WEBSITE
FOR UP TO DATE INFORMATION
REGARDING THE CANCELLATION
OR POSTPONING OF ALL
SCHOOL EVENTS

- 8/6 PUBLIC HOLIDAY
Queen's Birthday
- 16/6 Governing Council Meeting
6.00pm
- 3/7 Last day of Term 2
(2:05pm dismissal)

SCHOOL CLOSURE DAY 2020

Friday 4 September
Term 3, Week 7

PUPIL FREE DAYS 2020

Monday 7 September
Term 3, Week 8

* Please note there will be another
Pupil Free Day, date to be confirmed.

[Click here](#) to view our
online calendar

CONTACT

The Heights School
Brunel Drv, Modbury Heights SA 5092
Ph: (08) 8263 6244
Fax: (08) 8263 6072
E: dl.1430.info@schools.sa.edu.au
www.theheights.sa.edu.au

[f](#) /heightsschool



Government
of South Australia
Department for Education

PRINCIPAL'S MESSAGE

Reconciliation Week

Last week and this week we recognised and celebrated Reconciliation Week. National Reconciliation Week is held between the 27th May and 3rd June and is a time where Australians come together to join the reconciliation effort. It's a time where we learn about our shared stories and cultures and move forward towards a brighter and more equal future for all Australians.

On Monday, even though we are not yet gathering in assemblies, we utilised technology to partake in a virtual P-12 Reconciliation Assembly – *In This Together!*

Congratulations Mr Ian Benjafield and all teachers

Congratulations to our SACE Coordinator Mr Ian Benjafield on his nomination as one of the Advertiser and Sunday Mail's top public school teachers.

I learnt about this after reading a letter from Blair Boyer MP State Member for Wright.

Mr Ian Benjafield was described as a teacher who brings innovative ideas into the classroom to stimulate interest with positive results particularly in Year 12. With the onset of the COVID-19 crisis this year Ian was described as being incredibly supportive particularly with families who were nervous about the impact online learning would have on the students.

I am pleased Ian has been recognised and I'm also pleased to let you know we are very fortunate to have many teachers like Ian who have done and will continue to do the best job they can for our students and school.

Regular Attendance

The likelihood of success in learning is strongly linked to regular attendance and participation in educational programs.

We are striving to maintain high student attendance rates.

Our students' attendance rate is currently 87% and is yet to get back to the 90% mark or just over where it has consistently been for the last five years.

2019	90.7%
2018	91.2%
2017	91.5%
2016	90.9%
2015	90.7%

The importance of attending school regularly cannot be overstated. Students should have very few days absent each year. Many students achieve a 95% attendance rate or greater. This means they are absent for 10 or less school days per year.

Unless there are exceptional circumstances the number of days absent per year should be very small, no more than a handful and certainly less than 10. If your child is absent from school please account for their absence.



Volunteers' Week

Volunteers' Week was unfortunately postponed though we are hoping to have more and more of our valuable volunteers back with us soon.

Nigel Gill
Principal

CONTENTS

2	Around Our School
3-5	Building Better Schools 2020
6	Reconciliation Week
7	Community Liaison & Library News
8	CF11 Bear Hunt
9	Year 9 Stagecraft
10	Arts News & Year 12 Jackets
11	Maths Help Sessions

M&S CHARGE & BUILDING FUND REMINDER 2020

The Finance Office would kindly like to remind families the importance of paying or making payments toward 2020 Materials & Services Charges. The school offers many helpful and convenient ways to make payment and we encourage you to make contact with us so we can offer assistance. Payment of your child/children's Materials & Services Charges ensures the delivery of high quality resources and services for all and directly relates to higher educational outcomes.

If you are currently experiencing financial hardship due to a change of circumstance; such as a decrease to income or extensive medical expenses, please allow us to help with the application for Government assistance, alternatively applications can be completed online: <http://www.sa.gov.au/topics/education-and-learning/financial-help-scholarships-and-grants/school-cardscheme>

We would also like to take this opportunity to inform the community of our School Building Fund.

Contributions to this fund are completely voluntary. All donations are tax deductible and receipts are issued for this purpose. Building Fund contributions are solely used for the upgrade of student used facilities and building improvements (flooring, painting).

Previously we used these funds to fully upgrade our kitchen facilities accessed by our Secondary students.



BEFORE



AFTER

We appreciate many families may have recently been affected by COVID-19 in various ways, please remember we are here to assist.

We kindly thank families who have already made payment this year for Materials & Services and/or the Building Fund. We are grateful of your ongoing support. We thank others in advance for future payments.

The Finance Office is open Monday-Friday 8:30am-3:30pm.



Nationally Consistent Collection of Data

School Students with Disability

Nationally Consistent Collection of Data on School Students with Disability

All schools are required to collect information about the numbers of students that they provide adjustments to under the *Disability Discrimination Act (1992)* and *Disability Standards of Education (2005)*. This data is used as the basis for national funding.

This process will involve the collection of: the number of students receiving adjustments to enable them to participate in education on the same basis as other students; the level of adjustment provided to students; and where known, the student's type of disability.

Under the Collection model, the definition of disability is broad and includes learning difficulties, health and mental health conditions.

If your child is identified for inclusion in the Collection, the required information about your child will be included in this year's data collection.

If you have any questions about the data collection, please contact Laura Tambe at The Heights School on 8263 6244. Further information about the Collection can be found at:

<http://www.education.gov.au/nationally-consistent-collection-data-school-students-disability>.



BUILDING BETTER SCHOOLS 2020

Our \$10 million build is about to begin

It has been 2 years since the Government announced the Building Better Schools Funding.

The overall Project is governed by the Department of Planning, Transport & Infrastructure (DPTI) who conduct regular meetings consisting of our Lead Architects (Thomson Rossi), Cost Managers, Engineers and Department for Education representatives, which make up the Project Control Group.

On behalf of the school I'm so very proud to release images of our anticipated build, together with descriptors informing you of the amazing facilities that will become a part of our already well equipped and resource rich school.

If anyone has experienced extensions or renovations to their home, then you would know all too well the disruptions they cause and we are about to experience a bit of organised chaos as we navigate through our biggest building project to date.

Our students and families are at the heart of everything we do. Safety with minimal interruption to services will be our goal throughout, so I ask for patience and please follow any requests we must make to ensure builders are able to carry out the planned construction.

Builders will be officially taking over the areas identified for construction early next term. One of those areas is where our current Out of School Hours Care (OSHC) facility stands. The school is committed to continuous service of our OSHC and know how valuable this is for working families. Unfortunately, due to incidences out of our control (COVID-19 would be one of them), the new site funded OSHC building has been delayed by 4 months. This means for most of Term 3 and all of Term 4, the OSHC will be relocated within our school.

I would like to reiterate that there will be no disruption to service and our OSHC will continue to remain open throughout and provide high quality care for our students accessing this service.

Further details on the exact construction start-up date, changes to our school required to accommodate the builders and the relocation of our OSHC will be provided in the coming weeks.

And when the disruptions seem to be giving us all a bit of grief and inconvenience, we must remember to look back at these pictures because the outcome for our students is worth it.

Kindest regards,

Vicki Cook
Business Manager



FULL SIZE GYMNASIUM

- The gymnasium facades will feature glazed pull up style doors that will enable connections to the oval surrounds
- Complete with cutting edge audio visual technology to not only serve as a facility for team sports, but to host school assemblies and presentations
- Internally the gymnasium will also accommodate a general learning classroom for our Secondary students to balance physical activities with the theoretical demands of their study requirements



GYMNASIUM
INTERNAL IMAGE



GYMNASIUM EXTERIOR

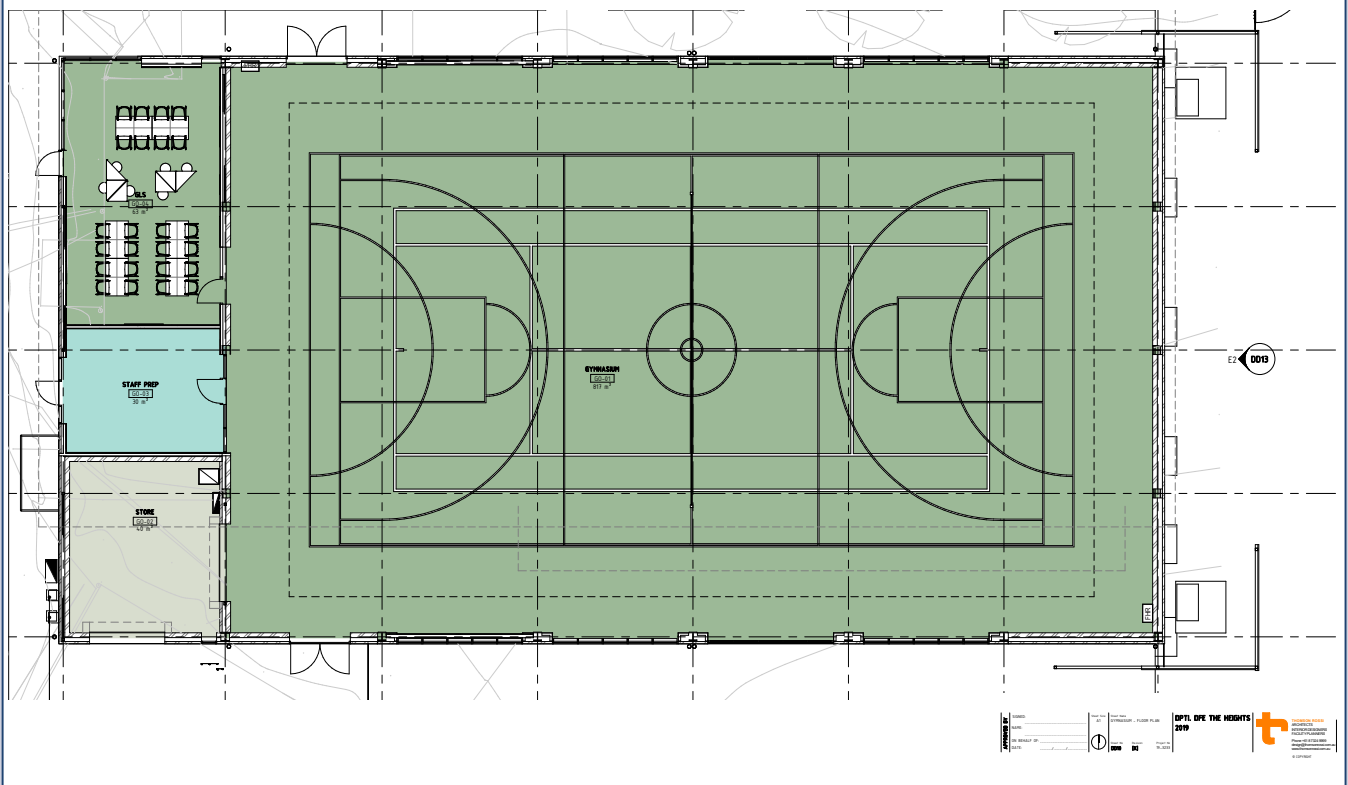

GYMNASIUM FLOORPLAN

PRIMARY LEARNING ENVIRONMENT

- The Primary facility will feature an inspiring and welcoming learning landscape, tailored to engage students, pursue their curiosity and share their discoveries
- Connecting the 2 Primary Wings is a centrally located fully covered outdoor area that will stimulate movement and physical activity, while encouraging project work and STEM activities
- The facility will accommodate 12 classrooms, circulation/breakout spaces, areas for group/individual work and the clever design incorporates infrastructure that allows technology to be accessible for learning anytime, anywhere
- Building foundations for independent thinkers and skilled learners who can meet the challenges of today and the future



CLASSROOM



CIRCULATION SPACE



COMMON LEARNING AREA



COVERED OUTDOOR COMMON SPACE

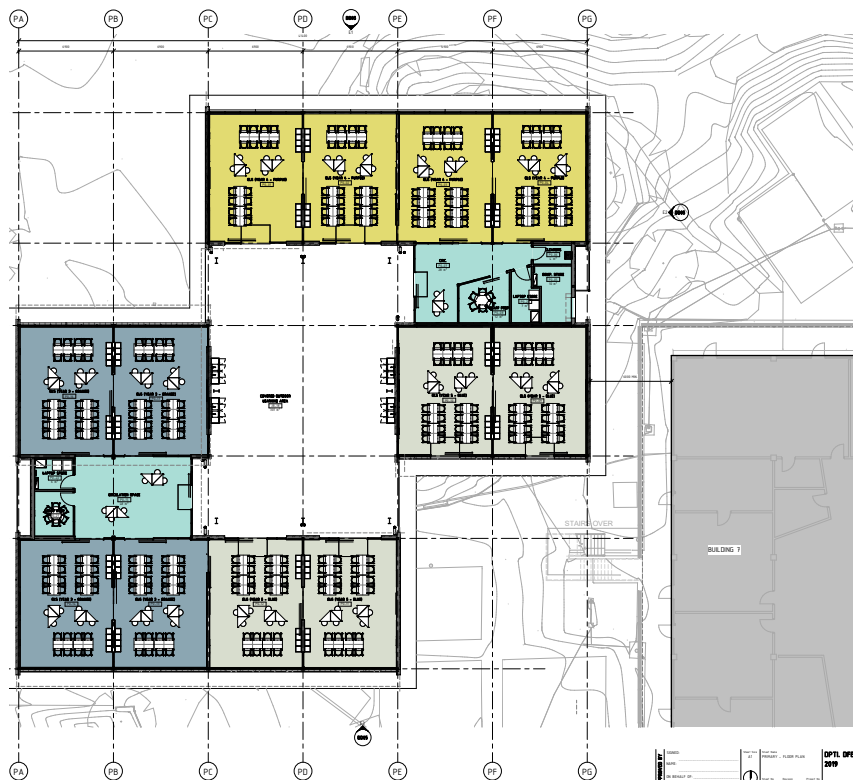

PRIMARY BUILD FLOORPLAN

RECONCILIATION WEEK

Students at The Heights School have been engaging in learning to support their understanding of the importance of meaningful reconciliation. Students learnt more about the Stolen Generations and recognised the importance of learning about the past so that we can move forward together with empathy as a united community. Teachers incorporated their understandings of the Australian Curriculum's cross-cultural Aboriginal and Torres Strait Islander perspectives into their teaching and provided opportunities for students to explore this through different learning areas. Next year we hope to be able to again welcome special guests into our school to share their culture and teach us new perspectives.

On Monday, we held our very first P-12 'Virtual Reconciliation Assembly'. This saw all students viewing the assembly in their classrooms. Students reflected on the pain and suffering of the Stolen Generations in recognition of National Sorry Day and learnt some Kurna language to pay respect to the Kurna people of the Adelaide Plains. Mr Gill spoke about the vital importance of acknowledging and paying respect to our first Australians and celebrating the cultural diversity that makes up our wonderful Heights School community.

Aboriginal Education Team

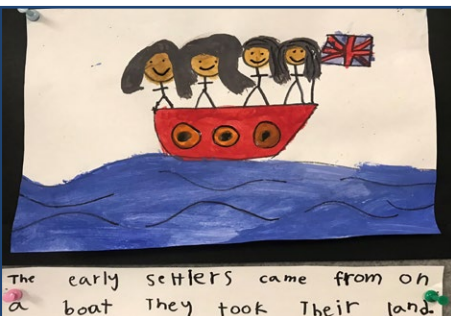

PEOPLE'S CHOICE COMMUNITY LOTTERY



people's choice
COMMUNITY LOTTERY

The Heights School will once again be participating in the People's Choice Community Lottery this year.

Since its inception in 1984 the community lottery has raised more than \$19 million around Australia with the registered groups keeping 100% of every ticket sold.

\$2 tickets will be available to purchase online soon and we look forward to sharing more information about this fantastic school fundraising opportunity with you as it becomes available.

NATIONAL SIMULTANEOUS STORYTIME

NATIONAL SIMULTANEOUS STORYTIME

Wednesday 27 May 2020

www.alia.org.au/nss

#NSS2020 #1MillionKidsReading



Australian Library and Information Association

SCHOLASTIC

LIANZA



The Heights School students participated in this year's National Simultaneous Storytime event which saw over 1 million students across Australia involved. The Australian Library and Information Association celebrate the event annually. This year's book was *Whitney and Britney: Chicken Divas* by Australian author and illustrator, Lucinda Gifford. Lucinda's book is a hilarious and sparkly story about two chickens who sleep by day, but turn into jazz singers at night.

As you can see, both our students and staff got involved in activities chosen to encourage engagement with the text. We hope you enjoy seeing the product of your students' experience as much as we do.

Kellye Rowe & Julie Simpson



CF11 - WE'RE GOING ON A BEAR HUNT

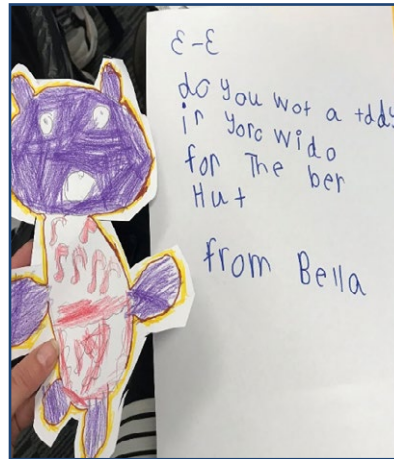

Students in CF11 are joining a global bear hunt, making walks around the school community even more entertaining.

Currently people all around the world have been putting teddy bears and other soft toys in windows, trees and on balconies, encouraging children to get outdoors for a walk with their parents while hunting for bears.

The hunt is inspired by the children's book 'We're Going on a Bear Hunt' by Michael Rosen and Helen Oxenbury, in which the characters sing: "We're going on a bear hunt, we're going to catch a big one — what a beautiful day, we're not scared."

CF11 have been working hard designing their own bears and writing letters to people in the wider community asking people if they would like to take part in displaying a bear in their window.

We have also been in contact with Mrs Luciano (who is currently on leave, working in New Zealand). We have organised to send her NZ class a bear to display in their classroom window.

How many bears can you see placed in the school?

Where to next? We hope to draw maps of the school and help make it easier for people to find the bears we've created around the school.

Furthermore we also have a collection of bears at the Modbury Heights Shopping Centre – in the newsagent, hairdresser, games shop and bakery.



YEAR 9 STAGECRAFT

This year, 9 students chose to create set design models from a range of plays. *Peter Pan* was the most popular choice with students creating exciting sets with entrances and exits from many different levels. This involved them in building stages that contained between 3 and 4 different sections. Some included the entire stage in their design of Captain Hook's boat - see Sarah, Harry and Vatsal's design. Mithuni, Kaili and Naishvi created fairytale lagoons which were perfect for Mermaids. Tryphena worked out how the children could be seen to leave London and fly through the night to Neverland. She created a model sized version of Big Ben and the Houses of Parliament and then worked out how to make them disappear! John and Aidan chose to create the set of *Look Back in Anger*. These models were built on a very small scale and included all the furniture, skylight and the attic roof mentioned in the set description. Emily negotiated to create a set for her favourite novel, *The Dog that Barked in the Night*. She designed and built an exciting set that provided potential actors with a "playground" to use in multiple ways. Her logbook was a work of art itself.

All these sets were designed from scratch using a choice of design briefs. Students had to work out what scene(s) they wanted to create and then how to construct it. They used a lot of numeracy skills to complete this task, measuring, scaling and proportion and even found an important use for Pythagoras' theorem in creating an accurate end on stage. The level of detail they have created is quite wonderful and their logbooks containing their thinking, planning and learning are worth reading too.

This exhibition is on in the Library for the next couple of weeks.

Sally Putnam
Drama Teacher



Adian - Look Back in Anger



John - Look Back in Anger



Harry and Vatsal - Pirate Ship



Emily - The Dog that Barked



Sarah - Peter Pan



Mithuni and Bernice - Ship

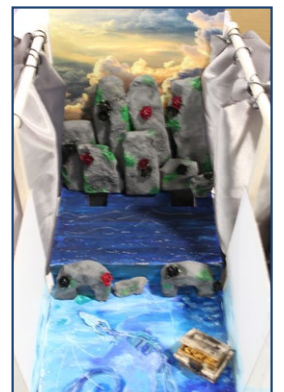

Mithuni and Bernice



Jelena and Tabitha



Naishvi and Kaili



Tryphena - London gone

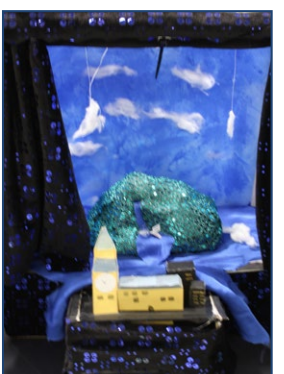

Tryphena - London to Neverland

VISUAL ART NEWS

Year 8 Art

Year 8 students have been creating watercolours drawn and painted from life and inspired by artist Fiona Hiscock. Next, students are getting ready to decorate some hand built ceramic vessels with their designs.

Professional Development Workshop: Teaching Visual Art with The Australian Curriculum

Primary school teachers, Catherine Di Tria, Zoe Skewes and Kate McMahon along with several other staff members enjoyed creating "Bearbots" and learning new art techniques and processes at a professional development workshop run by our Secondary Art teachers Catherine Bourn and Beth Sztekel.

Here are some of the Bearbots they created, with annotations identifying techniques, processes and visual conventions.

*Catherine Bourn
Visual Art Teacher*



YEAR 12 JACKETS

The new Year 12 jackets finally arrived and don't our students look smart! Pictured are some of our Year 12 students wearing the new jackets soon after their delivery.

*Arthur Roubanis
Stage 2 Coordinator*



MATHS HELP SESSIONS

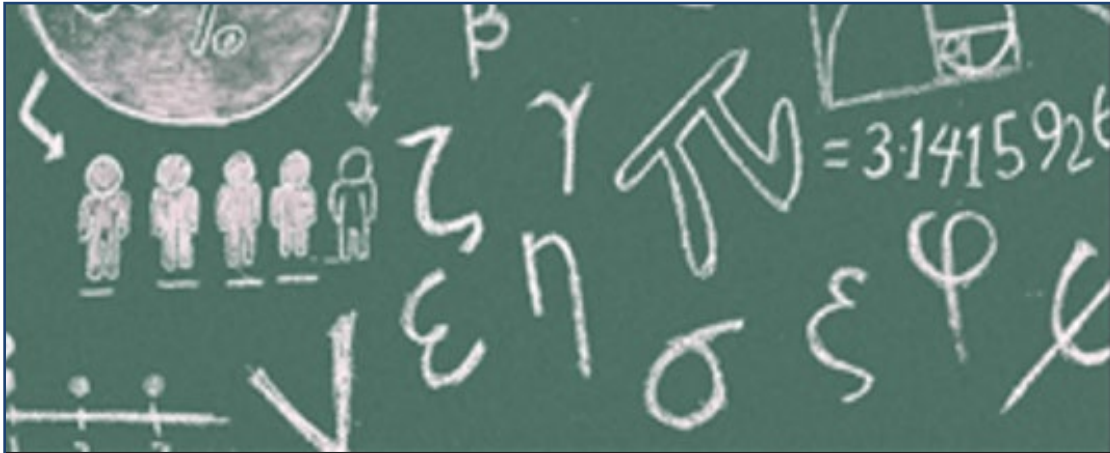

GOT A MATHS QUESTION THAT'S KEEPING YOU UP AT NIGHT?

MATHS HELP SESSIONS ARE HERE!

(YR 7 ONWARDS)

MATHS HELP

EVERY TUESDAY, WEDNESDAY AND FRIDAY
IN MF MIDDLE SPACE AREA AT LUNCH TIMES

TUESDAY: MS FAY, MS NOOR

WEDNESDAY: MR ROUBANIS, DR KHURMI

FRIDAY: MS KHANNA, MR SHAH, MS TRUEMAN